

SERIES 1900 DROP WEIGHT TESTER

**Performs Impact Resistance Tests
On Thermoplastic Pipe
According to ASTM Standards D-2444-80
...Tests Metals and Composites, Too**

Besides testing thermoplastic pipe, Series 1900 Drop Weight Tester performs nil-ductility tests on metals for ASTM E208 plus tear tests on ferritic steels according to ASTM E436. A motorized lift which operates on 110v/15 amps and has variable speed control raises the weight carriage to the selected drop height. Weight on the carriage can be adjusted to the desired amount. The raised carriage is

released by a 70 psi air-activated tripper. One of three interchangeable ASTM tup styles/sizes is mounted on the end of the weight carriage, depending on desired test results. The tester can be supplied in various heights to meet specific test requirements. Series 1900 has many outstanding design features which contribute to its efficient, convenient and safe operation:

- Hinged safety gates shield moving tester parts and specimen breakages from the operator. Interlocking switches stop tester's operation if safety gates are left open.
- Feet/inches height indicator for convenient and accurate positioning of weight carriage at desired drop.
- Specimen and fixture height can be compensated for through simple, manual adjustment.
- Automatic impact-actuated braking system holds rebounding weight carriage from bouncing back onto specimen after initial impact.
- A safety bar can be inserted to prevent raised weight carriage from making an undesired drop, causing possible injury or damage.
- A limit switch at top of tester prevents overtravel of weight carriage when raised by motorized lift. Overtravel indicator on control panel lights if weights reach this position.

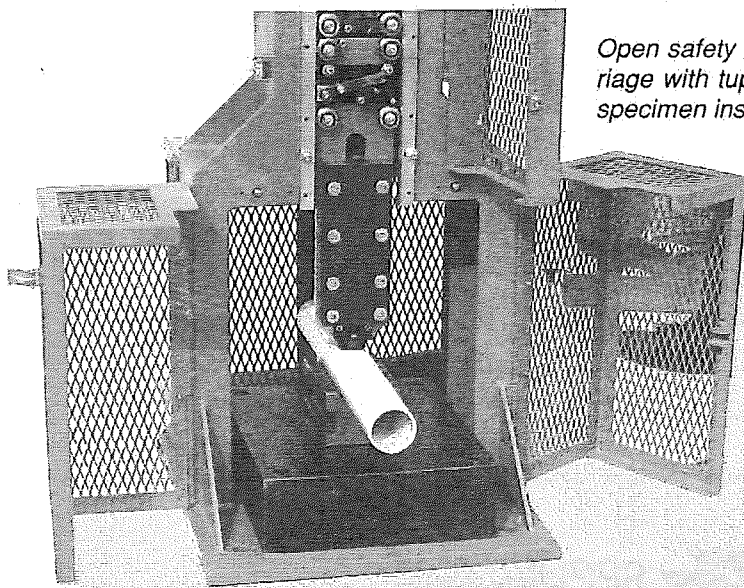

Open safety gates show weight carriage with tup on thermoplastic pipe specimen installed on V-type fixture.

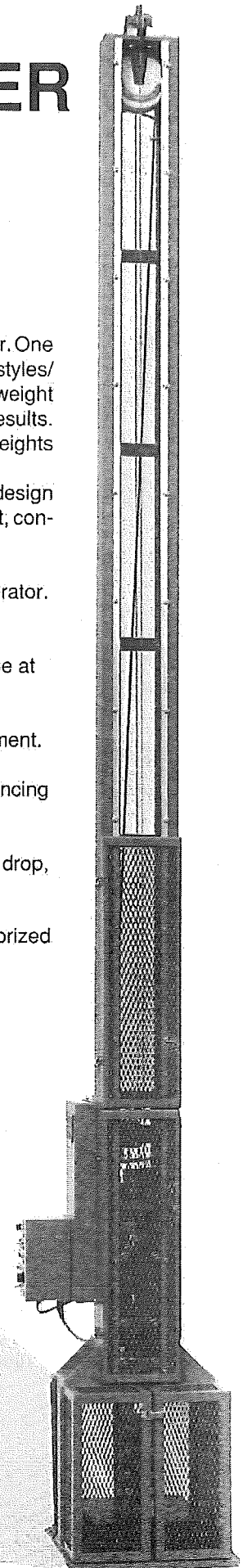

ACCESSORY EQUIPMENT

- A wide selection of tups, weights, specimen fixtures and stop blocks are available to meet various test requirements.
- Heat/cool temperature chambers.
- Digital drop height readout with optional automatic height stop.

CONTROLS

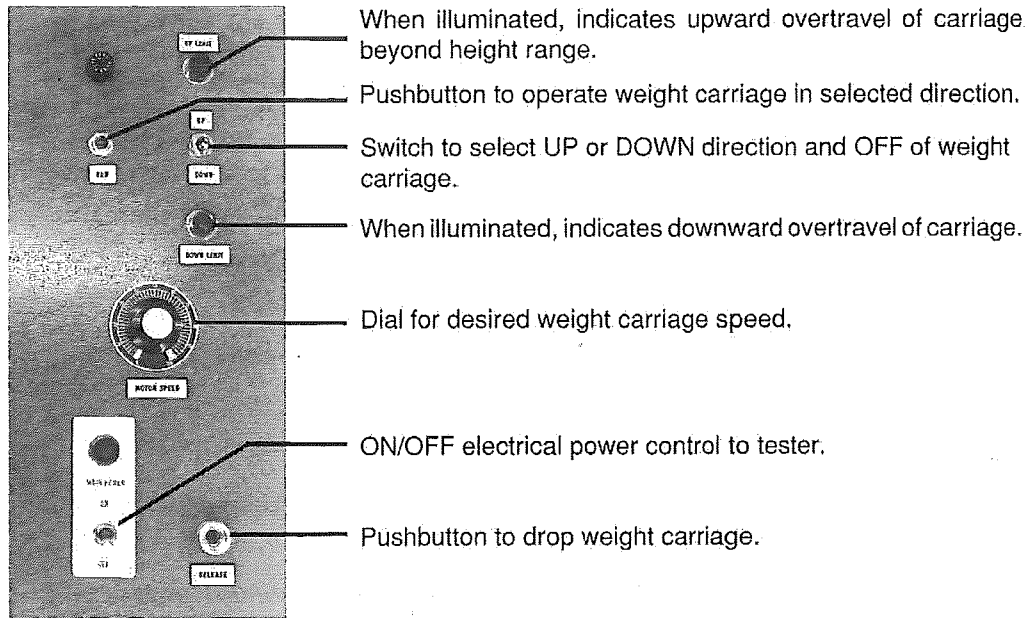

AVAILABLE TUP STYLES

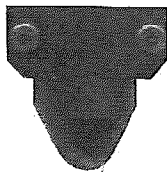

TUP (A)

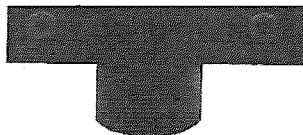

TUP (B)

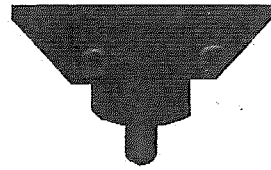

TUP (C)

TUP STYLE	RADIUS NOSE SIZE	ADJUSTABLE WEIGHT
(A)	1/2 - inch	6/12/20 lbs.
(B)	2 - inch	6/12/20 lbs.
(C)	1/4 - inch	6/12/20 lbs.

Note: Tup (C) causes the most damage. Using a 6/12/20 lb. tup equals a 200-ft. drop.

ATS APPLIED TEST SYSTEMS, INC.

348 New Castle Road • P.O. Box 1529 • Butler, PA 16003
Ph: 412/283-1212 • TLX: 86-6727 ATS BUTLER • FAX: 412-283-6570

MADE IN THE USA